



# Wodonga Caravan and Cabin Park SITE MAP

OFFICE HOURS: 9am – 7pm

CHECK OUT TIME 10am

**ENTRY - SLIDE THE BLACK TAG INTO THE BOOMGATE POST. PLEASE NOTE: THE GATE ONLY STAYS OPENS FOR 30 SECONDS.**

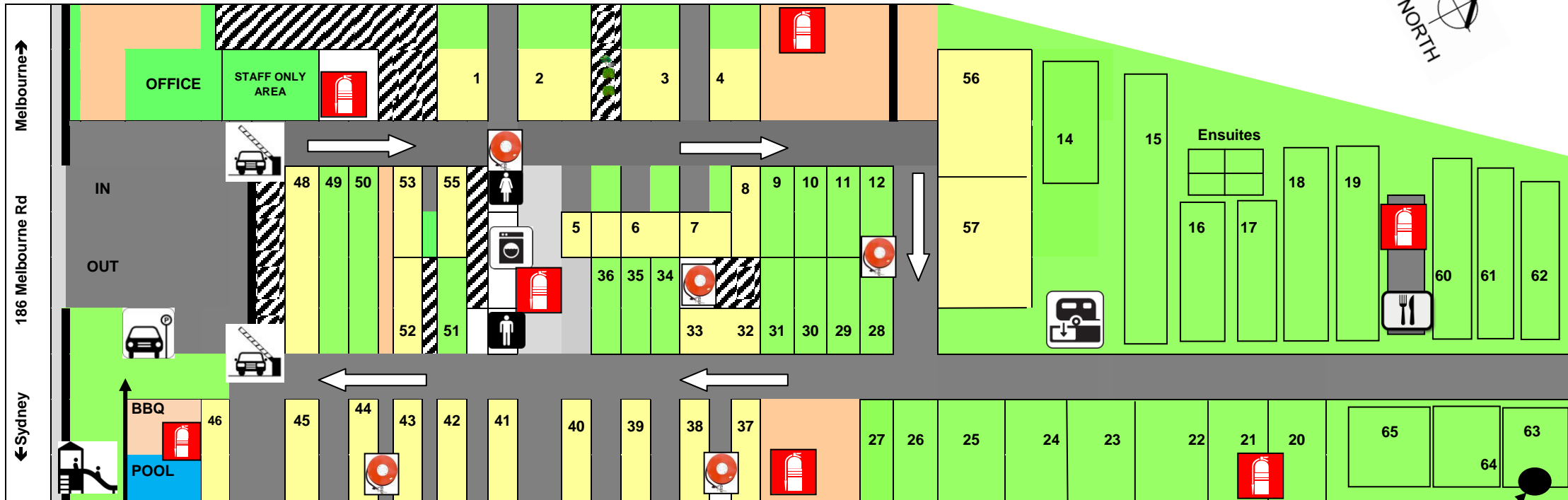

Water tank for fire fighting  
– 5000 gallons



**POWER in cabins:** If required a WHITE Key will be on the key ring to start power in the cabin. Push the key into the slot on the wall inside the cabin. Fridges always have power.

*Please remember to return keys to RECEPTION or the KEY BOX outside reception on your departure.*

	Fire Hose Reel		Fire Extinguisher		Boom Gates		Visitor Parking		Camp Kitchen		Playground
	Women's Toilet & Showers		Men's Toilet & Showers		Laundry		Dump Point				

TOILET ACCESS CODES ARE ON THE BACK OF THE KEY TAG

**BIKE RIDERS:** All persons riding bicycles MUST wear a bicycle helmet as per road laws and must obey speed and safety signs. Bicycles should only be ridden during daylight hours.

**CAMP KITCHEN:** A BBQ, kettle, toaster, microwave, fridge and hot plate/small oven are available for your use. Please ensure this area is left clean with all appliances turned off.

**CLEANING:** Management reserves the right to charge an extra cleaning fee if cabins are left in an unsatisfactory state.

**CLOTHES LINES:** are provided outside the amenities building. A dryer is available in the laundry.

**DAMAGE TO PROPERTY:** Park guests who damage park property and equipment (including the boom gates) will be held liable for the cost of repairs.

**DISPOSAL OF RUBBISH:** Garbage should be wrapped or bagged and placed in the red top rubbish bins. Recycle materials, bottle, cans, papers and boxes are placed in the yellow top recycling bins. The caravan park garbage disposal facilities should not be used for the disposal of anything other than normal household waste.

**ELECTRICITY:** In order to reduce energy consumption, guests are requested to turn off electrical appliances when they are not occupying the cabin during the day. This includes, TVs, lights, fans and air conditioners. Management reserves the right to enter a cabin to turn off unnecessary appliances. Also note that air conditioners or heating must be turned off in caravans that are not occupied during the day.

**FEES:** All fees are to be paid in full on or before arrival. Check in time is 2 p.m. Sites and cabins must be vacated by 10 am on the day of departure or late checkout fees are payable.

**FIRES:** Open fires are not permitted at any time (including wood/solid fuelled BBQ's) Fire bans are to be obeyed.

**GRIEVANCES:** Any grievances with other guests, park management or any employees of the park should be resolved using a private, conciliatory approach.

**ILLEGAL PURPOSES:** Guests must not use or permit the use of any sites or dwellings within the park for any purpose that is illegal at common law or under an Act.

**INTOXICATION and ILLEGAL SUBSTANCE ABUSE:** Drunkenness and the taking of illegal drugs will not be tolerated and will result in instant eviction.

**LAUNDRY:** Please remove washing promptly from the washing machines, dryer or clothes lines upon the completion of washing or drying. Park management may remove and store laundry items as a result of non-compliance. Change and laundry powder are available at reception.

**NOISE:** All guests are requested to keep noise to a minimum at all times. Please ensure there is no unnecessary noise between 10:00pm and 8:00am. TVs and radios must be turned down to a level which will not disturb neighbours.

**OFFENSIVE BEHAVIOUR/LANGUAGE:** will not be tolerated and will result in instant eviction.

**POLICE EVICTION:** If a person refuses to leave the park they may be liable to a charge of criminal trespass. If necessary, the police will be called to assist with eviction.

**PETS:** Guests' dogs and cats are welcome by prior arrangement subject to strict rules and guidelines. Pets are only permitted in management designated 'Pet Friendly Cabins'. Only 2 pets are allowed per cabin or site. Pets must not have access to cabin bedding or crockery. Pets must be on a leash at all times, fully controlled and well behaved. Pet owners are required to immediately pick up and dispose of any dog or cat droppings. Pets should not be left unattended in vehicles, caravans or cabins. Pet owners should provide access to shelter, shade and provide adequate food and water. Note that having pets at the park is always subject to the management's sole discretion and certain restrictions may apply during school and/or public holidays. \*Failure to adhere to the above conditions will result in immediate eviction or extra cleaning costs or both.

**PLAYGROUND:** Playground equipment should be used in the proper manner and in accordance with any rules specific to the particular apparatus. Ball games should not be played in the playground, in or around the amenities block or within close proximity of a dwelling.

**REPAIRS TO VEHICLES:** Repairs to vehicles should not be carried out within the caravan park unless an appropriate time and place has been agreed to by the park managers.

**SMOKING:** All cabins are NON-SMOKING. No smoking is permitted in the amenities block, camp kitchen or pool enclosure.

**SPEED LIMIT:** This is 8 km/h.

**SUPERVISION OF CHILDREN:** Adults must maintain sufficient supervision of their children within park grounds and are responsible for any damage caused. Children under the age of 5 years must be accompanied by an adult to the amenities block.

**SWIMMING POOL:** (Seasonal) No running, pushing or boisterous behaviour in the pool area. No glassware, food or smoking in the pool enclosure. Children under the age of 12 years and older children that are not capable swimmers must be supervised by an adult when using the pool. No pets are allowed in swimming pool area. Opening times at management's discretion.

**TRENCHING:** Trenching around tents or annexes is not permitted.

**VEHICLE ACCESS:** Each site is restricted to one motor vehicle unless prior arrangement has been made with the park managers. Please ensure that your vehicles are locked and all valuable items are out of site or removed.

**VISITORS:** All Visitors must report to reception upon arrival. Guests are responsible for their visitors. Visitors must vacate park by 10 pm.

**WASTE WATER and SULLAGE:** Waste water from caravans must be directed into the sullage points.

**WATER USAGE:** All park guests are asked to carefully regulate the use of water. Water usage should be in compliance with any water restrictions mandated by North East Water.